

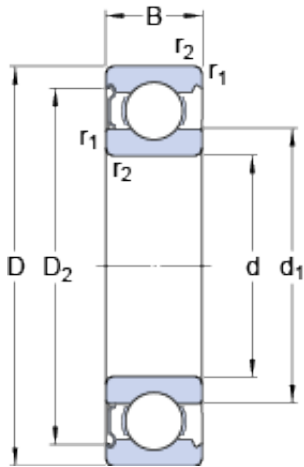

NTN-BOWER LTD.



100 mm x 215 mm x 47 mm SKF 6320-Z GERMANY Bearing 100X215X47

Bearing No. 6320-Z

6320-Z Bearing 2D drawings and 3D CAD models

Size	215x100x47 mm
Bore Diameter	215 mm
Outer Diameter	100 mm
Width	47 mm
d	100 mm
D	215 mm
B	47 mm
d ₁	135,85 mm
D ₂	183,8 mm
r _{1,2} - min.	3 mm
d _a - min.	114 mm
d _a - max.	135,9 mm
D _a - max.	201 mm
r _a - max.	2,5 mm
Basic dynamic load rating - C	174 kN
Basic static load rating - C ₀	140 kN
Fatigue load limit - P _u	4,8 kN
Reference speed	6700 r/min
Limiting speed	4300 r/min
Calculation factor - k _r	0,03
Calculation factor - f ₀	13
d ₁	135.85 mm
D ₂	183.8 mm
r _{1,2} min.	3 mm



NTN-BOWER LTD.

d_a min.	114 mm
d_a max.	135.9 mm
D_a max.	201 mm
r_a max.	2.5 mm
Basic dynamic load rating C	174 kN
Basic static load rating C_0	140 kN
Fatigue load limit P_u	4.75 kN
Calculation factor k_r	0.03
Calculation factor f_0	13.2
Mass bearing	7.14 kg